

REVELSTOKE SELECT

*presents*

# Mountain Lake Chalet

Revelstoke, British Columbia

2025/2026  
RATES & TERMS







## *Introducing* **Mountain Lake Chalet** *Secluded, Private, Spacious*

Welcome to Mountain Lake Chalet, a luxury ski chalet offering unmatched privacy and seclusion on four private acres at the south end of Williamson Lake, with helicopter access.

Secluded in unmatched privacy, Mountain Lake Chalet is a 6,258 sq. ft. architectural masterpiece, seamlessly blending sophisticated design with the breathtaking natural beauty of Revelstoke.

Nestled at the south end of Williamson Lake, this exclusive retreat is framed by open fields and the majestic Selkirk Mountains—offering an unparalleled balance of adventure and serenity.

4 SPACIOUS BEDROOMS  
UP TO 10 GUESTS

FULLY SERVICED STAYS OPTIONAL



# The *Ultimate* Mountain Retreat

Mountain Lake Chalet invites adventurers and serenity seekers alike to experience the ultimate mountain retreat, where breathtaking natural beauty and refined luxury come together in perfect harmony.

Fully serviced stays are optional and tailored to suit your needs. Enjoy the services of a private chef, personally curated menus and meals, home stocking services, daily housekeeping, in chalet massage and yoga, each adding to an elevated holiday experience.

Just minutes from Revelstoke Mountain Resort and the upcoming Cabot Revelstoke championship golf course, Mountain Lake Chalet offers both seclusion and convenience.

With direct access to the coveted Williamson Lake, guests can enjoy boating, paddle boarding, and ice skating in the winter, while world-class skiing, heliskiing and backcountry tours are just moments away.

Short drives brings you to the anticipated Cabot Revelstoke Golf Course clubhouse, Lake Revelstoke, and downtown Revelstoke's shopping and dining scene.

Whether you're planning a family getaway, a retreat with friends, or an exclusive alpine escape, Mountain Lake Chalet offers an unparalleled blend of luxury, adventure, and tranquility—year-round.

6,258 SQ FT OF  
LUXURY LIVING





# Main Level

## Living

Perfect for hosting, Mountain Lake accommodates up to 10 guests with a beautiful dining area, a cozy living room with a fireplace, and panoramic windows that blend indoor comfort with stunning outdoor views.

The fully equipped chef-inspired kitchen features bar seating and a convenient coffee counter, perfect for anything from quick snacks to gourmet meals prepared by a private chef. Accompanied by a functional service pantry and additional prep area.

The cozy living room offers a warm retreat with a fireplace and expansive windows showcasing breathtaking outdoor views. Four spacious main bedrooms, each with a private ensuite, provide ultimate comfort and privacy for guests.

Vaulted living room ceilings  
*with soaring floor to ceiling windows*

Expansive open living spaces  
*overlooking meadows, Williamson Lake and the foot of the Selkirk Mountains*

Stunning wood-burning fireplace, with rock surround

Sonos surround sound





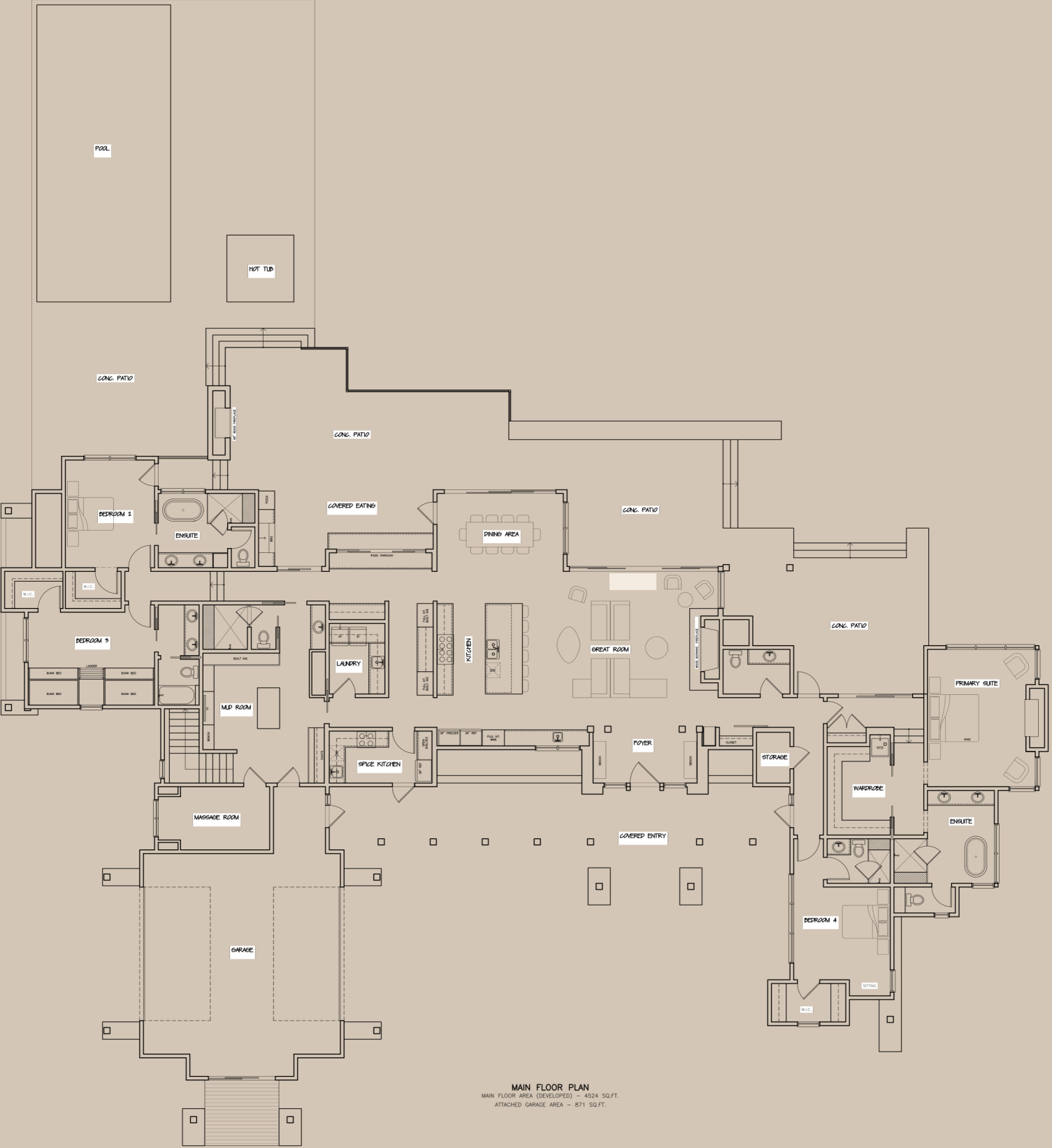

## *floor plan* Main Level

Elegant entry, with views to the lake

Drive-through 2-car garage

Beautifully appointed living spaces

Chef-inspired kitchen with dining island

- 36" Sub Zero Refrigerator*
- 36" Sub Zero Freezer*
- 24" Gaggenau Wine Fridge*
- 48" Thermador Pro-Style Dual-Fuel Range with 6 Star Burners*
- 24" Double Drawer Sisher & Paykel Dishwasher*
- Wolf Espresso Coffee Maker with Warming Drawer*

### Chef's Spice Kitchen

- Private entry*
- Ample space for staff and preparations*
- 30" Thermador Gas Range*
- 48" Traulsen Commercial Refrigerator/Freezer*
- 24" Asko Dishwasher*
- Microwave*
- Stocked with essentials - spices, oils, vinegars, coffee, teas*



# Main Level

## Amenities

Comfortable and spacious gear room with access from garage

Forced-air boot warmers

Lounge seating with easy access to breakfast bar and espresso maker

Steps away from a marble-surround steam shower

*Spacious bench seating with shower, luxury robes and shower amenities*

Massage room

Access to exterior deck and the enjoyment of exquisite outdoor amenities

*Spacious hot tub*

*Plunge pool*

*18' x 40' outdoor heated swimming pool (summer access)*

*Outdoor kitchen, BBQ, seating and dining spaces*

*Steps to the shoreline of Williamson Lake and summer enjoyment -*

*swimming, tadpole hunting, kayaking and paddle boarding*

Access to north and south sleeping rooms and lower level







PRIMARY



BEDROOM 2



BEDROOM 3

## Main Level *Bedrooms + Baths*

### South Bedrooms

#### Primary Bedroom - King Bed Configuration

*Expansive windows overlooking meadows and lake*

*Gas burning fireplace*

*Samsung Frame TV*

*Power privacy window coverings*

*Oversized ensuite with rain shower, soaker tub,  
double vanity and water closet*

#### Bedroom 2 - King or Split Twin Bed Configuration

*Flexible configuration from king to split twin beds*

*Ensuite with single vanity and rain shower*

### North Bedrooms

#### Bedroom 3 - King or Split Twin Bed Configuration

*Beautiful meadow and lake views*

*Flexible configuration from king to split twin beds*

*Ensuite with rain shower, soaker tub, double vanity and water  
closet*

#### Bedroom 4 - Bunk Room with 2 Double Bunks

*Spacious bunk room sleeps 4*

*Double beds with independent lighting*

*Ensuite with rain shower, tub, double vanity and water closet*

**SLEEPS 9 INDEPEDENTLY**



## Lower Level

As expansive as the main level, the lower level of Mountain Lake Lodge is where relaxation, recovery, conditioning and entertaining happens.

For those seeking an exceptional workout, the private, professionally designed gym is fully equipped. Coupled with a full bathroom and cedar lined sauna.

The games / media room is spacious for entertaining or simply getting away from it all. A wet bar, pool table, darts and large screen TV make this space comfortable and fun.

Bright functional spaces

Fully equipped, professionally designed gym

Cedar lined sauna

Full bathroom with rain shower

Media | Games room with bar fridge and wet bar

*Pool table, darts, Smart TV, lounge seating, Sonos surround sound*

*24" Marvel under counter Refrigerator*

*24" Marvel under counter Ice Machine*

*24" Fisher & Paykel Dishwasher*





*floor plan*  
Lower Level







*Revelstoke Select’s signature experience*  
begins well before you arrive in  
Revelstoke

As the local leader in bespoke luxury, Consider the Revelstoke Select Team as your personal concierge. We draw from decades of first-hand experience and the breadth of knowledge garnered from our long- term, best-in-class tourism and hospitality partners to tailor a luxury Revelstoke adventure be-fitting your style.

We are here to help, start your planning now:

**Transportation**

Group and Private Ground Transportation  
(Kelowna or Calgary / return).

**Private Heli Transfers**

(Kelowna or Calgary / return)

**Private Charter Flights**

(Kelowna or Calgary / return)

**Heli Ski Bookings**

**Revelstoke Mountain Resort**

Lift Tickets, Rentals, Instruction and Guiding



## *Let's Curate Your Perfect Stay!*

### Indulge in a Fully-Serviced Stay at Mountain Lake Chalet.

Enhance your stay with Revelstoke Select's fully serviced home experience.

Our serviced stay's include:

- Dedicated Lodge Manager
- Private Executive Chef crafting bespoke menus
- Wine consulting
- Breakfast, Après, Dinner, soft drinks and snacks
- Daily housekeeping & Laundering
- Professional Concierge Team to manage every detail

From gourmet breakfast to après-ski indulgences and exquisite dinners, every aspect of your stay is thoughtfully curated for effortless enjoyment.

With years of expertise in luxury hospitality, we ensure a seamless and refined experience.

For those seeking more, our Concierge Team can arrange heliskiing, VIP guiding, lift tickets, ski and touring equipment rentals, private yoga, in-chalet massage services, airport transfers, and more.

*When every moment counts*  
Revelstoke Select makes them unforgettable





Pricing  
& Terms

SEASON	DATES	RATES
		+16% TAX + DEPARTURE CLEAN (\$1050 + 5% GST)
OFF SKI SEASON	RMR Closing 2025 (anticipated Apr 21st) to RMR Opening 2025 (anticipated Dec 5th)	\$3,200CAD
SKI SEASON (LOW)	RMR Opening 2025 - Thursday, Dec 18th 2025  Sunday, Mar 29th, 2026 - RMR Closing 2026 (anticipated Apr 20th)	\$3,700CAD
SKI SEASON (REGULAR)	Sunday, Jan 4th - Thursday, Feb 12th, 2026  Sunday, Feb 22nd - Saturday, March 28, 2026	\$4,200CAD
SKI SEASON (HIGH)	Friday Dec 19th, 2025 - Saturday Jan 3rd, 2026  Friday Feb 13th - Saturday Feb 21st, 2026	\$5,200CAD

MINIMUM 5-NIGHT STAYS - All seasons  
MAXIMUM NUMBER OF GUESTS: 10  
DAMAGE DEPOSIT WILL BE TAKEN AT TIME OF CHECK IN (\$2,500)







# *Pricing* & Terms

## Terms

A 25% deposit is due to secure the booking. If cancellation is less than 90 days prior to the rental period, the deposit shall be forfeited to the Owner as damages.

If cancellation is 89-60 days prior to rental period, 60% of the rental fee shall be non-refundable and forfeited to the Owner as damages.

If cancellation is less than 60 days prior to the rental period, 100% of the rental fee shall be non-refundable, forfeited to the Owner as damages.

Please reference the Vacation Rental Agreement for complete terms.

CHECK IN: 3PM  
CHECK OUT: 10AM





# Getting to Revelstoke, BC

There are several options when traveling to Revelstoke.

As you book your stay, our Operations Team can assist with arrangements for shared or private ground transportation or private jet and heli transfers from the Calgary and Kelowna airports.

*Please Enquire*

- Revelstoke, BC 
- Airports 

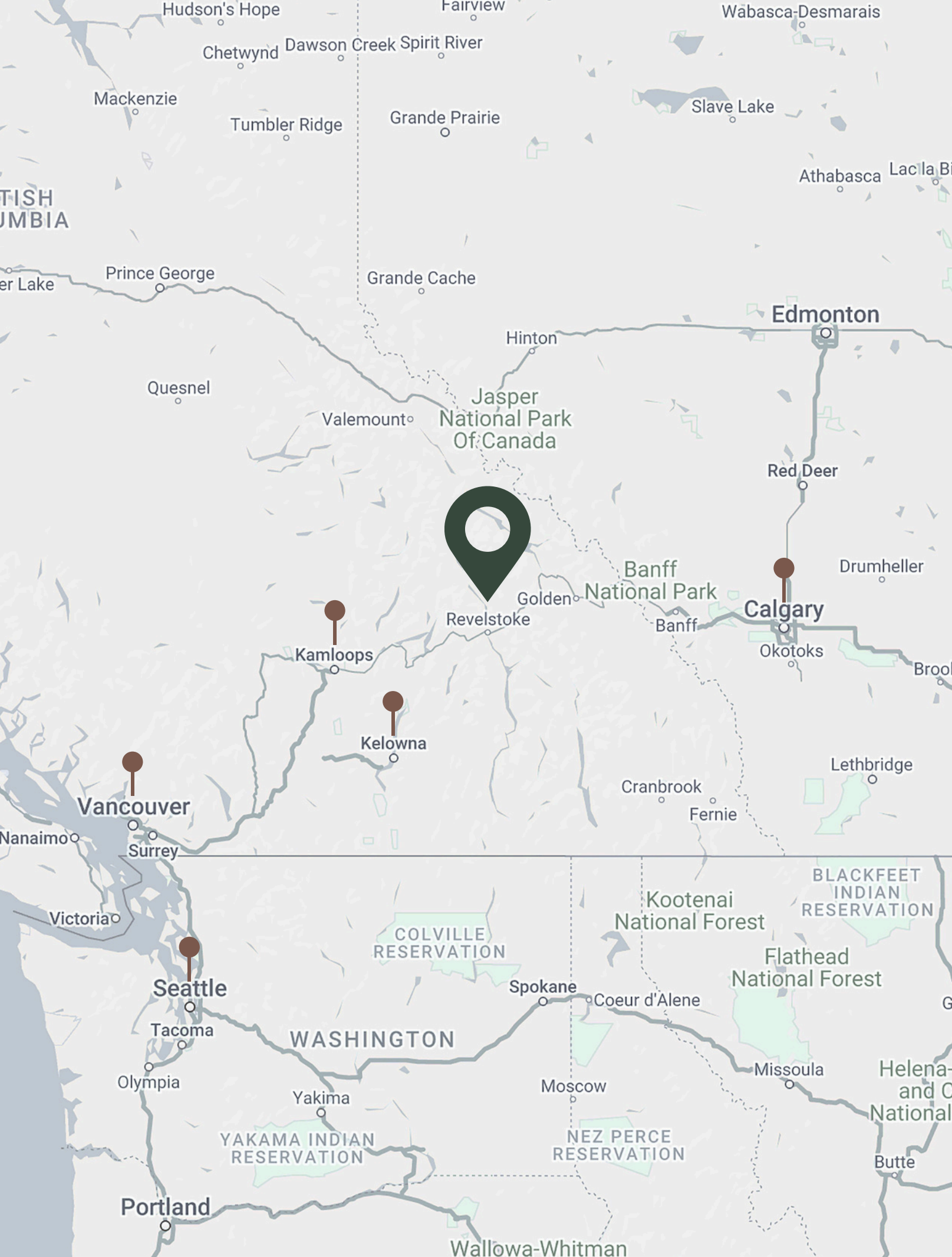





*We look forward*  
to hosting you at the  
chalet this season

*Revelstoke Select Vacation  
Properties Inc.*

250-200-0066  
info@revelstokeselect.com

*Mountain Lake Chalet*

2580 Airport Way  
Revelstoke, British Columbia V0E 2S0





